

RBC2 Round Belt Curve
Instruction & Maintenance Manual
RBC2 圆带弯道安装使用维护手册

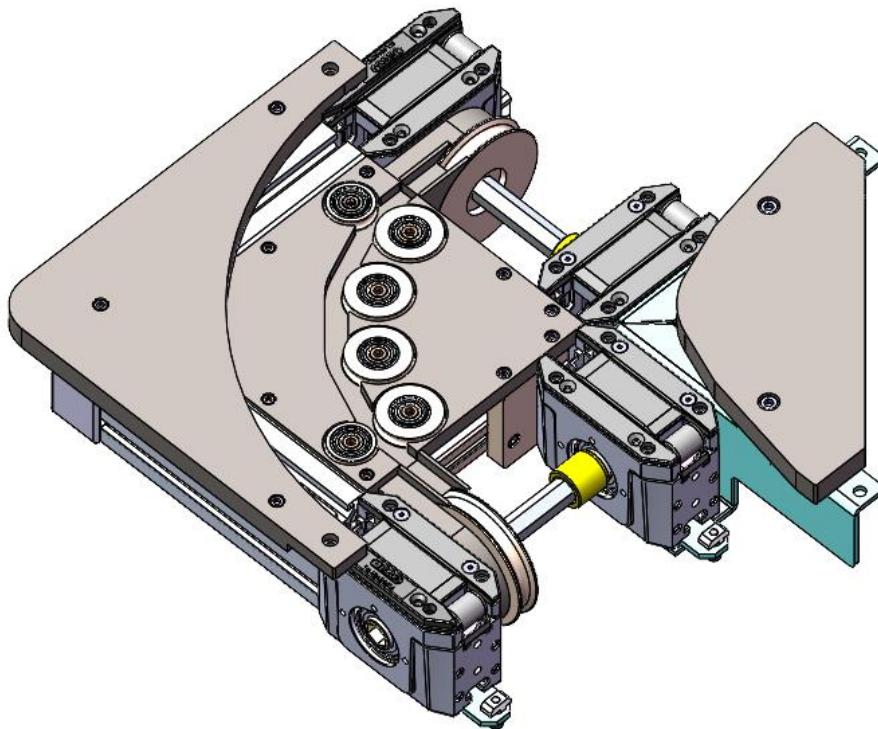

Suzhou LinkedGo Transfer System Co.,Ltd.

苏州领科工业技术有限公司

Structure Diagram 结构示意图

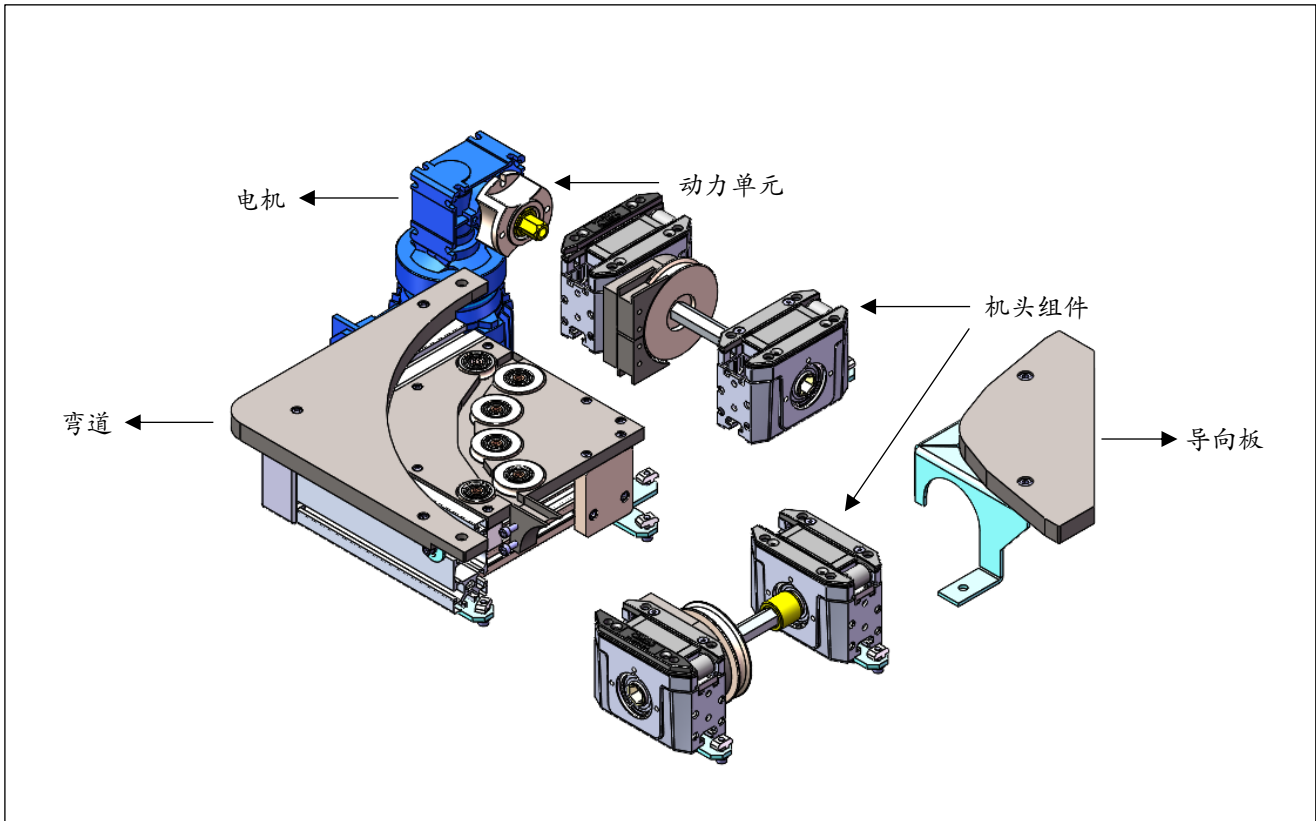

- 1、 The circular belt bend is used to change the running direction of the workpiece tray and maintain the original positioning of the workpiece (the front end is always the front end)
- 1、 圆带弯道用来改变工件托盘的运行方向，并保持工件原来的定位（前端始终为前端）。
- 2、 The conveying medium is a circular belt.
- 2、 输送介质为圆形皮带。
- 3、 It can be divided into two types of curved conveying: 90° and 180° .
- 3、 可分为 90° 和 180° 两种弯道输送。
- 4、 The total weight of the workpiece tray can reach up to 20kg.
- 4、 工件托盘总重量最多达 20kg。
- 5、 Only suitable for environments without grease and oil.
- 5、 只适合于无润滑脂和无油的环境。

Model Description 型号说明

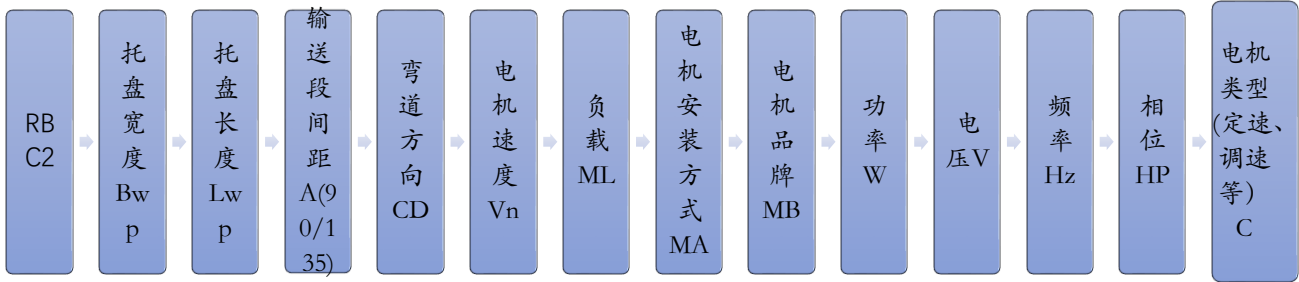

例: RBC2-Bwp160-Lwp160-A90-CDR-Vn12-ML30-MAL011A - MBNORD-120W-380V-50Hz-3HP-C0

参数说明 Parameter Description

The model RBC2-Bwp160-Lwp160-A90-CDR-Vn12-ML30-MAL011A - MBNORD-120W-380V-50Hz 3HP-C0 represents a fixed speed motor with a tray width of 160mm, The distance between conveyor sections A (RBC2/180 only) is 90, tray length of 160mm, right bend direction, running speed of 12m/min, running load of 30kg, motor installation position L011A, motor brand NORD, power of 120W, voltage of 380V, frequency of 50Hz, and phase of 3.

型号 RBC2-Bwp160-Lwp160-A90-CDR-Vn12-ML30-MAL011A - MBNORD-120W-380V-50Hz-3HP-C0, 表示托盘宽度 160mm, 托盘长度 160mm, 输送段间距 A (仅限于 RBC2/180) 为 90, 弯道方向为右, 运行速度 12m/min, 运行负载 30kg, 电机安装位置为 L011A, 电机品牌为 NORD, 功率为 120W, 电压为 380V, 频率为 50Hz, 相位为 3。

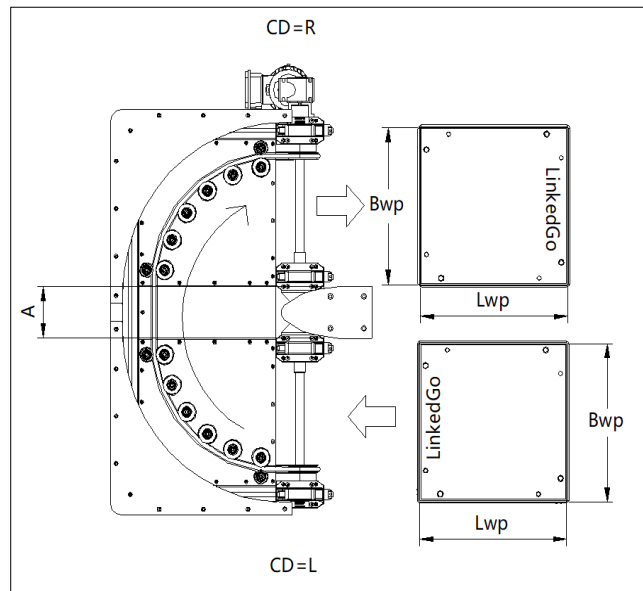
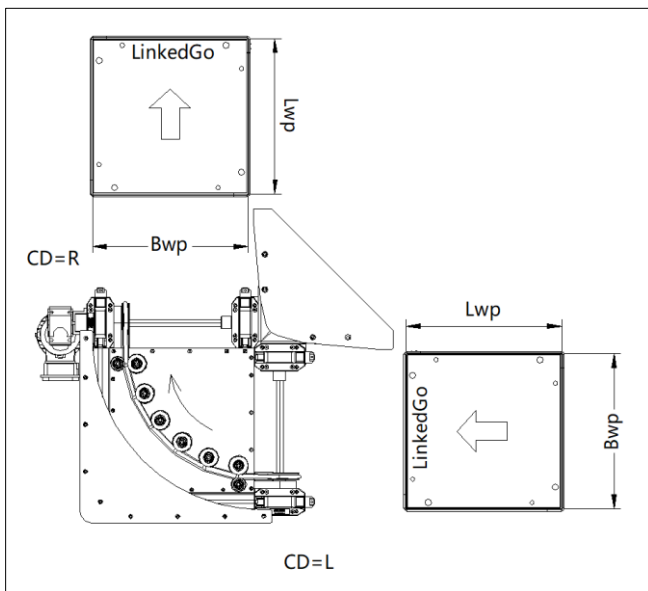

产品特征

安装步骤

维护保养

安装步骤 Installation steps

A Install the roller onto the bottom plate as shown in the following diagram.

A 按下图所示，将滚轮装到底板上。

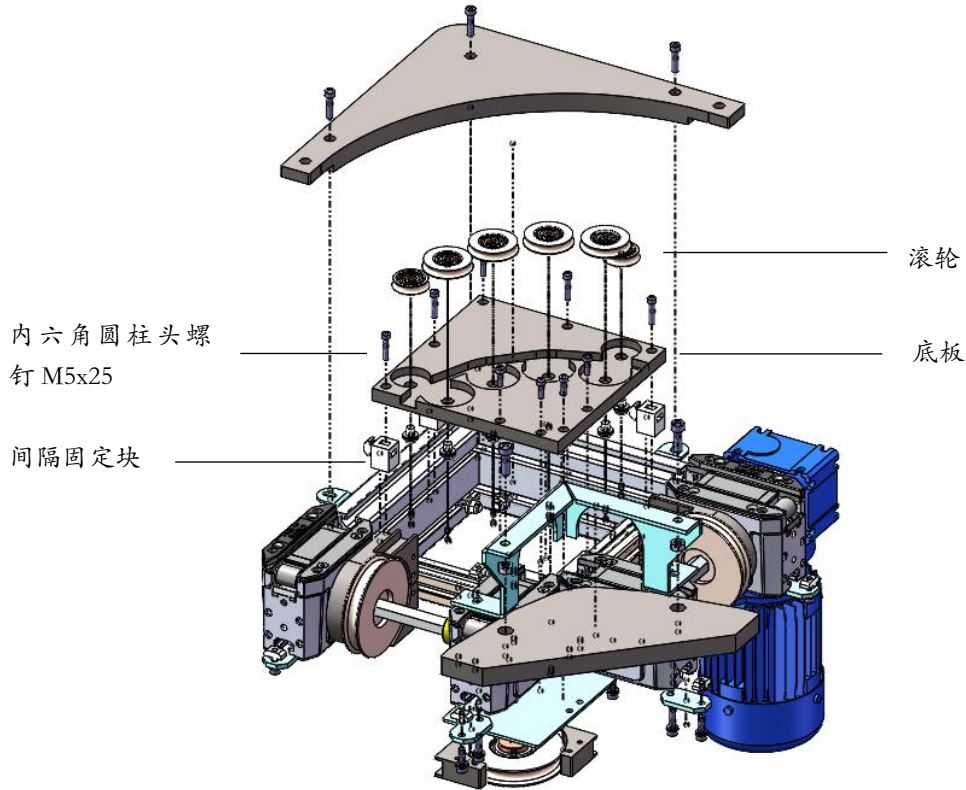

B Lock the bottom plate onto the profile with screws and spacer fixing blocks.

B 将底板用螺丝和间隔固定块锁到型材上。

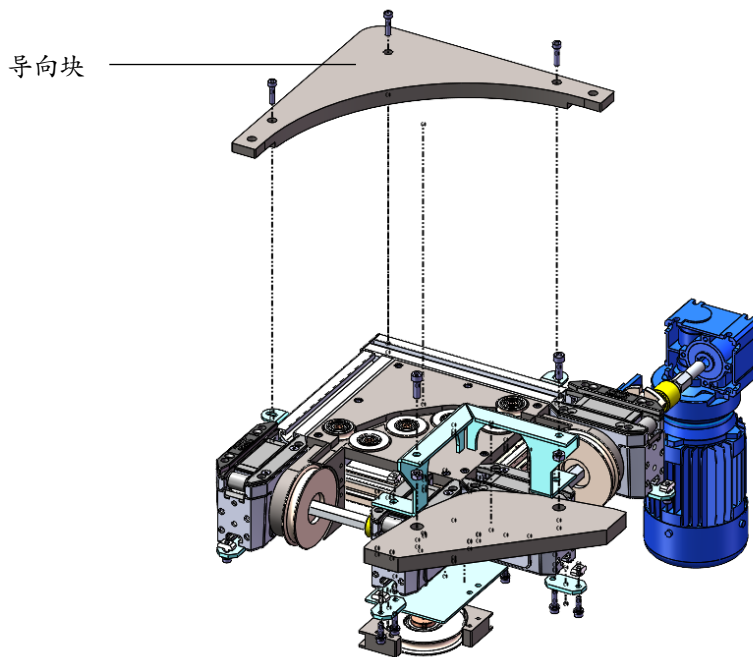

产品特征

安装步骤

维护保养

C Lock the guide block onto the profile.

C 将导向块锁到型材上。

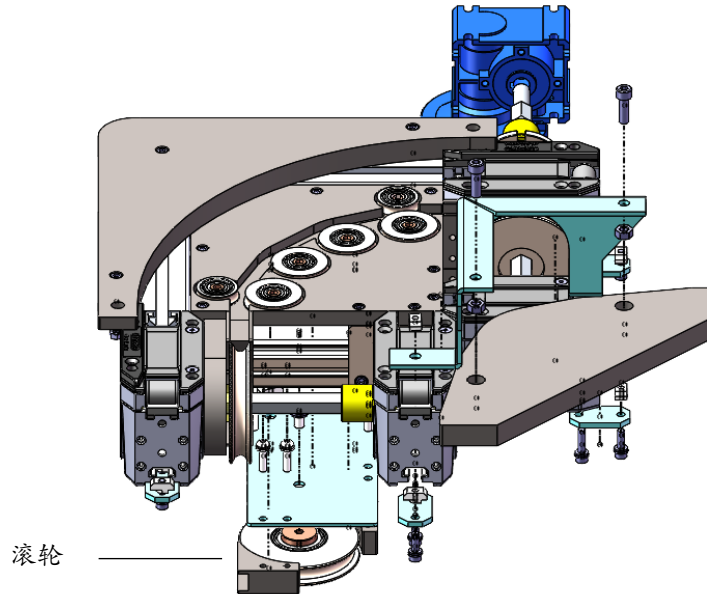

D Install the roller onto the wheel mounting plate and then fix it onto the profile.

D 将滚轮装到带轮安装钣金上，随后固定到型材上。

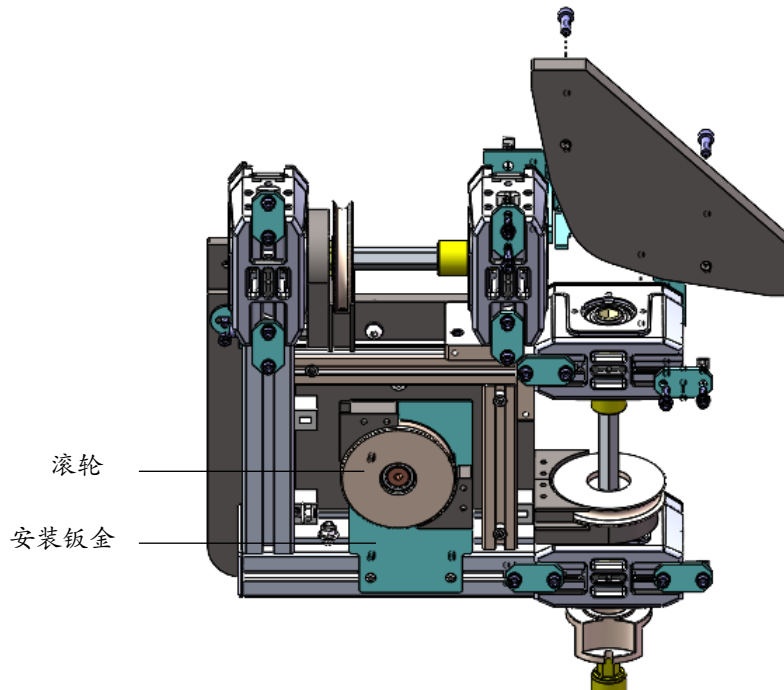

E Lock the support plate gold onto the machine head.

E 将支撑板金锁到机头上。

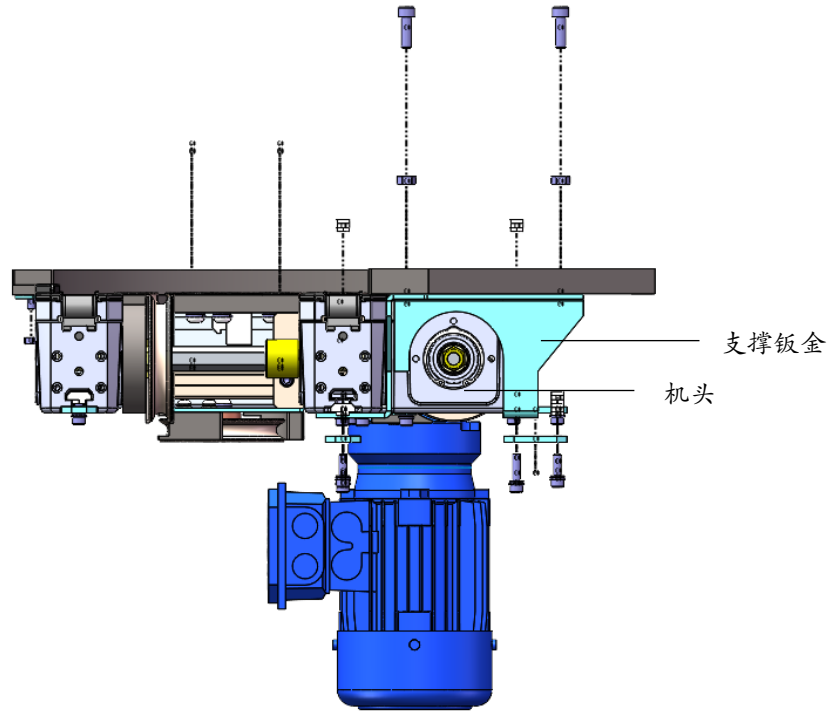

F Lock the guide block onto the support plate metal.

F 将导向块锁到支撑板金上。

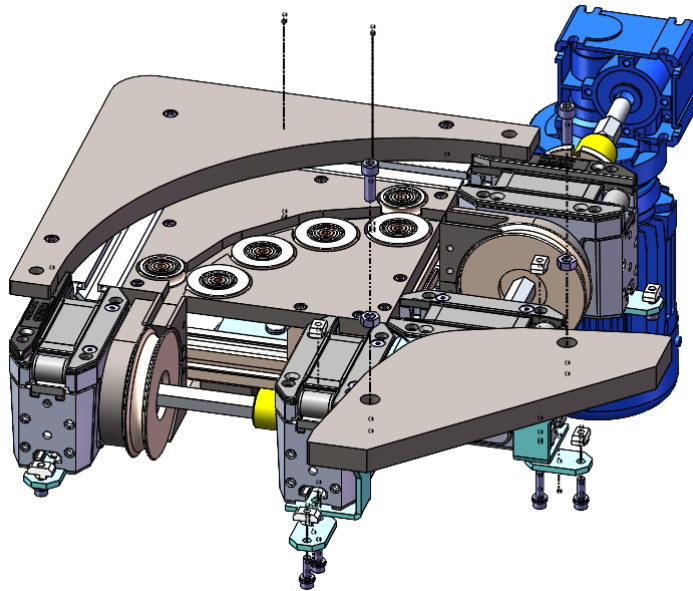

G Installing the motor.

G 安装电机。

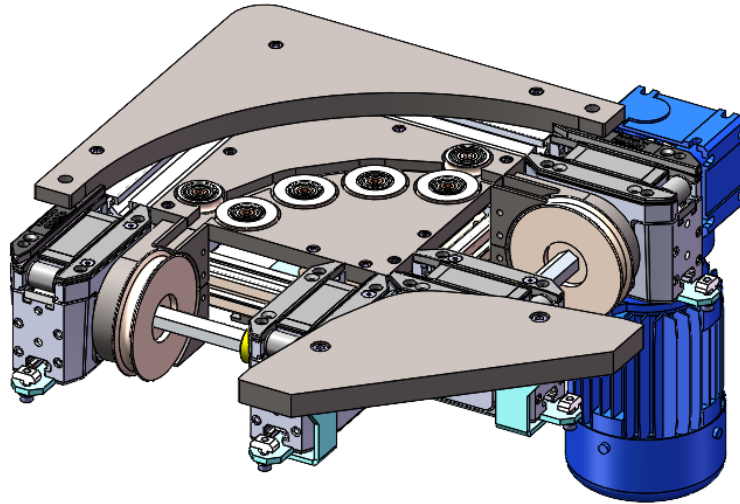

H Install the circular belt.

H 安装圆皮带。

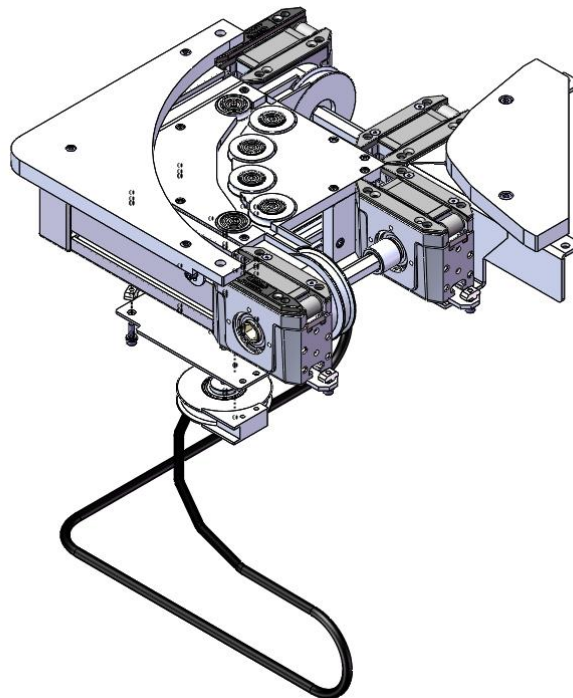

Maintenance 维护和保养

The UTS series tray conveying system requires regular maintenance and upkeep to extend the service life of the line. The conveying equipment should be kept clean to avoid direct sunlight or rain or snow, and to prevent contact with substances such as acids, alkalis, oils, organic solvents, etc.

UTS 系列托盘输送系统需按周期进行规定的保养维护工作，以延长线体使用寿命。输送设备应保持清洁避免阳光直射或雨雪浸淋，防止与酸、碱、油类、有机溶剂等物质接触。维护前需关闭对应的能源供给。

Daily Maintenance

日维护

Regularly clean the conveyor line. Before starting the machine every day, it is necessary to clean the floating dust, falling small parts, and other obstacles on the chain and wire body to prevent dust and dirt from affecting the operation of the wire body. When cleaning the machine head, it is necessary to remove the upper cover of the machine head and use an air gun to remove any accumulated dust inside. During trial operation, check all parts of the conveyor line for abnormalities, such as loose bearings or abnormal noise. Once any abnormalities are found, repair and replace them immediately. The steel wheel chain needs to be lubricated daily. 定期清洁输送线。每日开机前需清理链条及线体上的浮尘、掉落的小零件及其他障碍物，防止积尘和污垢影响线体运行。在清洁机头时，需拆掉机头上盖，用气枪清除里面积压的灰尘。试运行前，检查输送线的各部位是否有异常，如轴承有无松动或异常噪音，一旦发现异常应即使维修和更换。钢制轮链条需每日润滑。

Weekly Maintenance

周维护

Regularly inspect the accessories on the conveyor line body. For easily damaged parts such as sprockets, bearings, and idlers, regular inspection, maintenance, and lubrication are required. If damage or looseness is found, it must be replaced immediately. Check if the fasteners on the wire body are loose and tighten them in a timely manner.

定期检查输送线体上的附件。对于链轮、轴承、惰轮等容易损坏的零件，需定期检查、保养和润滑。发现损坏和松动须立即更换。检查线体上的紧固件是否有松动情况，及时紧固。

Quarterly maintenance

季度维护

Check if the guide strip and friction strip are severely worn or deformed, and replace them in a timely manner. Confirm that the running condition is good, observe if the chain is loose, and if there is any looseness, shorten the chain length by removing the chain link.

检查导向条、磨擦条是否磨损严重或者变形，并及时更换。确定运行状况良好，观察链条是否松弛，如有松动，可通过去除链节的方式缩短链条长度。

Disclaimer

免责声明

The customer shall inspect the equipment regularly. If the customer fails to maintain the conveyor as the state above, leading to any malfunction or damage to the conveyor, our company will not be responsible for it, all related costs (including material costs, installation and commissioning fees, and hotel expense) shall be borne by the customer.

客户应定期对设备进行检查。若客户未按要求对输送机进行维护，进而导致输送机发生任何故障或损坏，我司将不承担相关责任，由此产生的相关费用（材料费，安装调试费，差旅费）均由客户承担。

Suzhou LinkedGo Transfer System Co.,Ltd.
苏州领科工业技术有限公司

[Tel: +86-512-6636 1885](tel:+86-512-66361885)

Add: Room 706, Building D, Dongchuang Science and Technology Park, No. 216 Jinfeng Road, Wuzhong District, Suzhou, P.R. China

Zip code:215101

E-mail: Sales@LinkedGo.com.cn

Website: [www. LinkedGo.com.cn](http://www.LinkedGo.com.cn)

Subject to technical modifications

电话：+86-512-6636 1885

地址：苏州市吴中区木渎镇金枫路 216 号东创科技园 D 幢 706 室

邮编：215101

邮箱：Sales@LinkedGo.com.cn

网址：www.LinkedGo.com.cn

我司保留技术更改的权利